



| CUBE |

WORLD CLASS STORAGE

FEATURES

- Steel inner liner
- HC refrigerants as standard
- Low service costs
- Custom made design
- Long life
- 5 different sizes
- Partially self closing lid
- 77 mm insulation
- Environmental friendly
- Graphics (option)
- Scoope (option)

At first sight it may look like a traditional freezer for ice cream and frozen food but furthermore we can offer very high quality and reliability. New technologies has allowed us to use compressors with very low energy consumption, which also includes the use of hydro carbons. The lid system is unique. Once you get to the final part of the closing process, the lid is partially self-closing.



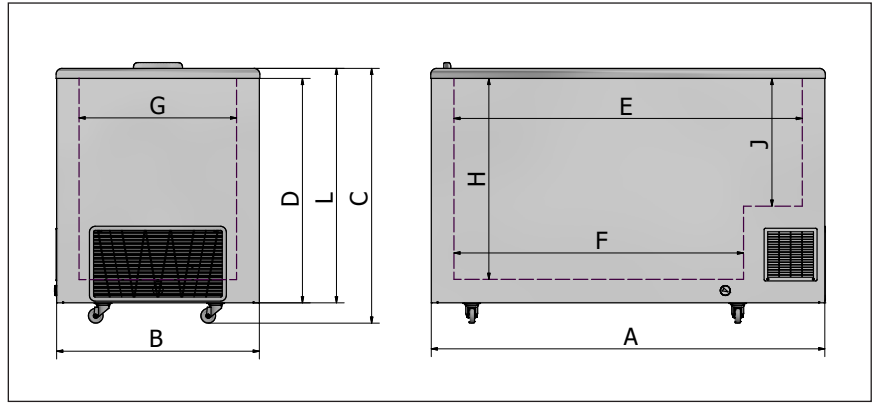

Rail for self closing lid.

	CUBE 22	CUBE 35	CUBE 45	CUBE 53	CUBE 61
Climate class 4+	4+	4+	4+	4+	4+
Ambient temp. Range (F)	+61 to +95	+61 to +95	+61 to +95	+61 to +95	+61 to +95
Gross volume, cub. feet	7.24	11.69	15.04	17.76	21.26
Net volume, cub. feet	5.76	9.43	12.18	14.41	17.27
Temperature range inside unit (F)	+3 to -10	+3 to -10	+3 to -10	+3 to -10	+3 to -10
Refrigerants available: R290	Yes	Yes	Yes	Yes	Yes
Energy consumption(kwh)/ 24 h, climate class 4+	2.2	2.9	2.9	3.2	3.5
Input power (watt)	228	300	337	350	352
DIMENSIONS					
External dimensions (wxdxh), inch	30.0x27.3x34.1	43.0x27.3x34.1	52.9x27.3x34.1	60.7x27.3x34.1	71.0x27.3x34.1
Internal dimensions (wxdxh), inch	23.9x21.1x27.1	36.9x21.1x27.1	46.7x21.1x27.1	54.6x21.1x27.1	64.8x21.1x27.1
Dimension A (inches)	30.0	43.0	52.9	60.7	71.0
Dimension B	27.3	27.3	27.3	27.3	27.3
Dimension C	34.1	34.1	34.1	34.1	34.1
Dimension D	28.1	28.1	28.1	28.1	28.1
Dimension E	23.9	36.9	46.7	54.6	64.8
Dimension F	16.0	29.0	38.8	46.7	56.9
Dimension G	21.1	21.1	21.1	21.1	21.1
Dimension H	27.1	27.1	27.1	27.1	27.1
Dimension J	15.1	15.1	15.1	15.1	15.1
Dimension L	29.4	29.4	29.4	29.4	29.4
Insulation (inch)	3.0	3.0	3.0	3.0	3.0
ACCESSORIES					
Dividers	optional	optional	optional	optional	optional
Max number of baskets (option)	2	3	4	5	6
Castors	incl	incl	incl	incl	incl
Castors w brakes	optional	optional	optional	optional	optional
Lock	optional	optional	optional	optional	optional
Thermometer	optional	optional	optional	optional	optional
Internal light	n/a	n/a	n/a	n/a	n/a
OTHER DATA					
Graphics	optional	optional	optional	optional	optional
Outer cabinet	white	white	white	white	white
Inner cabinet	steel inner liner	steel inner liner	steel inner liner	steel inner liner	steel inner liner
Type of cooling	static	static	static	static	static
Type of defrost	manual	manual	manual	manual	manual
Power 110 volt / 60 hz	yes	yes	yes	yes	yes
Thermostat	mechanical	mechanical	mechanical	mechanical	mechanical
Net weight	99	117	134	150	156
Gross weight	106	125	143	158	165
SHIPPING					
20 ft container capacity	42	30	24	20	18
40 ft container capacity	84	62	50	44	38
40 ft HC container capacity	126	91	74	66	55
Standard trailer capacity	153	105	84	78	66